

# SCANNER

Epson Perfection™  
V33 & V330 Photo

**EPSON**  
EXCEED YOUR VISION

## Exceptional scanning quality and versatility at your fingertips



**IMAGING  
INNOVATION**

Epson's constant innovation in imaging solutions give you the best performing scanners that exceed your vision.

- **Unsurpassed image quality in high resolution**  
Enjoy extraordinarily high optical resolution of 4800dpi and optical density of 3.3 for more effective and convenient archiving of important details
- **Greater efficiency in a single scanner**  
Allocate up to 10 personalised job settings effortlessly with customisable one-touch operation
- **Superior scanning features for complete digital imaging solutions**  
Experience better text readability and image visibility with Auto Area Segmentation and extended language support in searchable PDF
- **Easy scanning of films with built-in TPU** (for V330 Photo)  
Built-in moving TPU with film holder holds a capacity of 6-strip film in 35mm and 4-frame mounted slides in 35mm

## IMAGING INNOVATION

Epson's constant innovation in imaging solutions give you the best performing scanners that exceed your vision.



Epson Perfection™ V33



Epson Perfection™ V330 Photo

### Unsurpassed image quality

With a high resolution of 4800dpi and Matrix CCD™, you can be assured that every intricate detail in your images will be captured and preserved. In addition, original colours and details can be accurately reproduced with 48 bit colour depth and embedded ICC profile.

### Customisable one-touch operation for your convenience

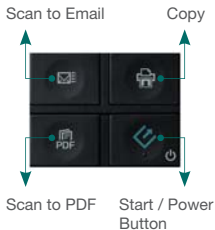

Four one-touch buttons on the control panel are pre-defined with Copy, Start, Scan-to-Email and Scan-to-PDF functions.

Allocate up to 10 settings effortlessly through Epson Event Manager to suit your personal preferences. Experience customisation at a convenience and versatility like never before.

### Versatility and convenience with a single software Epson Scan v3.9

Epson Scan v3.9 facilitates rotational view of documents and additional language support in searchable PDF. The Auto Area Segmentation function also allows separate scanning of both image and text in a document.



Auto Area Segmentation: Off



Auto Area Segmentation: On

### Effortless film scanning\*



Expect hassle-free back up and digitisation of your film collections with built-in Transparency Unit (TPU) which holds a capacity of 6-strip film in 35mm and 4-frame mounted slides in 35mm.

\* Applicable only for Epson Perfection™ V330 Photo

## Zero warm-up time, eco-friendly feature

With Epson ReadyScan LED Technology, scanning starts instantly with no warm-up time required. In addition, the technology is environmentally friendly as it is mercury-free, low in heat dissipation and power consumption.

## Quality image enhancement functions

Epson Scan v3.9 is a complete digital imaging solution that enables greater customisation and controllability to achieve picture perfection:

### Colour Restoration Feature

Restore original colours of faded photos to make them look new again.

### Dust Removal Tools

Removes flaws such as dust and scratches from defective photos.

### Backlight Correction Features

Automatically analyses and makes necessary adjustments to the brightness, sharpness and colour balance of each image.

### Text Enhancement Feature

Enhances sharpness of text when scanning text documents. Primary colours of red, green, blue can also be separately enhanced or dropped from a scanned document.



Before



After

## Exceptional scanning quality and versatility at your fingertips

Epson Perfection™ V33 and  
Epson Perfection™ V330 Photo,  
the very best in complete home  
digitisation solutions.



## Bundled software for easy digitisation of documents

Sharing, managing and backing up your documents have never been simpler with Epson Perfection™ scanners.

### ABBYY Finereader Sprint 9 (ver. 8 for Mac)



This Optical Character Recognition software allows you to transform scanned paper documents into editable computer files. In addition, languages like Traditional and Simplified Chinese, and Japanese are supported.

### Arc-soft Scan-and-Stitch Deluxe



You can now scan documents larger than A4 size with this software that automatically rotates, aligns and stitches multiple sections of a page into a single seamless image. Save the final image in JPG, BMP or TIFF format.

## PARTNERS IN PERFECTION



Epson AcuLaser™ M1200



Epson Stylus® Office T30

Designed to offer unsurpassed quality and value with reliability, Epson Stylus® Office T30 and Epson AcuLaser™ M1200 are easily your perfect choice of printers. You can now be assured of durability, outstanding print and image quality and enjoy significant cost advantages.

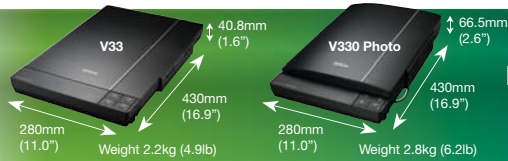

**Epson Perfection™  
V33 & V330 Photo**

**SPECIFICATIONS**

\*1 Available with ABBYY FineReader Sprint

\*2 To use the USB port, consult the documentation provided with your PC for further information about USB connectivity. Please note that errors may occur if non-standard cables or multiple hub connections are used.

\*3 USB2.0 Host Driver by Microsoft is required

\*4 iMac/ iBook/Power Book/ Power Macintosh of USB2.0/F standard equipped

Scanning Speed Data Patterns  
The thumbnail images below show the scanning patterns used to determine scanning speed specifications.



^1

Line Art  
(MEMO)

^2

Photo  
(Photo courtesy  
of ISO/JIS-SCID.  
Reprinted by  
permission.)

System Configuration of Scanning Speed  
CPU: Intel Core™ 2 CPU 6700 @ 2.66GHz  
RAM: 2 GB  
I/F: USB2.0 Hi-Speed  
OS: Windows® XP Professional Edition  
Soft: Adobe Photoshop 7.01E

Scanning speed test results vary according to system configuration, dpi setting, and scan mode setting. However, documents and photos other than those pictured above can be substituted without significantly affecting test results.

As an International ENERGY STAR Partner, EPSON has determined that this product meets the International ENERGY STAR program for energy efficiency.



EPSON is the registered trademark of Seiko Epson Corporation.

All other product names and other company names used herein are for identification purposes only and are the trademarks or registered trademarks of their respective owners.

EPSON disclaims any and all rights in those marks. Scan/Print samples shown herein are simulations. Specifications are subject to change without notice.

<b>PRODUCT CODE</b>	B11B200403 and B11B200413		
<b>MODEL NUMBER</b>	V33 and V330 Photo (with Film Scanning)		
<b>BASIC</b>			
SCANNER TYPE	Flatbed colour image scanner		
OPTICAL RESOLUTION	Main 4800 dpi x Sub 9600 dpi		
DOCUMENT SIZE	216 x 297 mm (A4, US Letter size document)		
REFLECTIVE	32.9 x 24.4 mm (35 mm x 6 frames Strip film, 35 mm x 4 frames mounted slides)		
TRANSPARENCY	Hi-speed USB 2.0		
INTERFACE			
<b>CONFIGURATION</b>			
PHOTOELECTRIC DEVICE	Epson Matrix CCD™ (12 line colour CCD with On Chip Micro Lens)		
LIGHT SOURCE	122,400 pixels (10,200 x 4 lines x 3 colours)		
SUB-SCANNING METHOD	White LED		
	Fixed document and moving carriage		
<b>PERFORMANCE</b>			
OUTPUT RESOLUTION	50 to 6400, 9600, 12800 dpi (50 to 6400 dpi in 1 dpi increments)		
COLOURS	Internal 48 bit (281.5 trillion colours), Output 48 bit (281.5 trillion colours)		
	24 bit (16.7 million colours), 16 bit (65,536 grayscale levels), 8 bit (256 grayscale levels)		
	1 bit Monochrome		
<b>SCANNING SPEED</b>		<b>Speed Priority Mode</b>	<b>Best Mode</b>
<b>REFLECTIVE SCANNING</b>			
MONOCHROME *1	A4 600dpi	Approx. 2.9 msec/line	25 sec
	A4 1200dpi	Approx. 10.1 msec/line	101 sec
	A4 4800dpi	Approx. 21.8 msec/line	NA
	A4 600dpi	Approx. 3.5 msec/line	30 sec
	A4 1200dpi	Approx. 10.1 msec/line	102 sec
	A4 4800dpi	Approx. 21.8 msec/line	NA
24bit COLOUR *2			
<b>FILM SCANNING (V330 ONLY)</b>		<b>Speed Priority Mode</b>	<b>Best Mode</b>
35MM POSITIVE FILM	2400dpi	Approx. 8.5 msec/line	34 sec
	3200dpi	Approx. 8.5 msec/line	41 sec
	4800dpi	Approx. 8.5 msec/line	64 sec
35MM NEGATIVE FILM	2400dpi	Approx. 12.3 msec/line	44 sec
	3200dpi	Approx. 12.3 msec/line	55 sec
	4800dpi	Approx. 12.3 msec/line	85 sec
<b>FUNCTIONS</b>			
IMAGE QUALITY ENHANCER	PRINT Image Matching II ICC Profile Embedded Backlight Correction Colour Restoration Dust Removal Grain Reduction Selectable Tone of Auto Exposure Unsharp Mask with Noise Reduction De-Screening with Document Type Optimizer Tone Curve Adjustment with Histogram Resizable Preview Window		
EASY SCANNING	4 Push Buttons with customisable job settings with Epson Event Manager Multiple page scan to PDF feature High Compression PDF Searchable PDF *1 Text Enhancement Auto Area Segmentation Colour Enhance and Dropout features Correct Document Skew User defined setting name Stand-Alone Application and Scan to File Feature Multi Document Auto Detection Multi Document Auto Cropping Auto Skew Correction Auto Photo Orientation Multi Marquee Film Scanning Thumbnail Preview		
<b>SUPPORTED PLATFORMS</b>			
USB1.1 & 2.0 *2	Microsoft® Windows® XP Home Edition/XP Professional/ XP Professional x64 Edition/ Windows Vista™ / Windows® 7 *1, Mac OS® X 10.3.9 or later (Universal version) *4		
<b>ENVIRONMENTAL CONDITIONS</b>			
TEMPERATURE	10°C to 35°C [50°F to 95°F] (Operating), -25°C to 60°C [-13°F to 140°F] (Storage)		
HUMIDITY	10% to 80% without condensation (Operating), 10% to 85% without condensation (Storage)		
<b>ELECTRICAL SPECIFICATIONS</b>			
VOLTAGE	(AC100V model) AC100-120V 50-60Hz, (AC200V model) AC220-240V 50-60Hz		
POWER CONSUMPTION	Power Off: 0.5W, Operating: 12.0W, Ready Mode: 5.5W, Sleep Mode: 3.7W		